

Curvature +0.25
-0.70

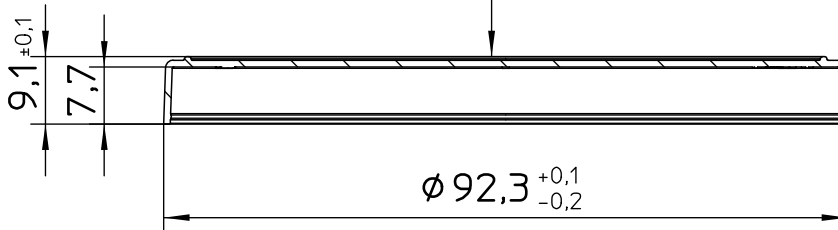

$\phi 89,05^{+0,1}_{-0,2}$



Curvature +0.70
-0.15

$\phi 87,05$

"All dimensions in mm"

Customer drawing subject to change without notice!

Uncontrolled Copy

Prior Issue	Drawn	Approved	Released	CONFIDENTIAL: Information contained in this document or drawing is confidential and proprietary to Greiner Bio-One GmbH. This document may not be reproduced for any reason without written permission from Greiner Bio-One GmbH. All rights of design, invention, and copyright are reserved.
Revision 6	Date 2011/03/07	Date 2023/11/22	Date 2023/11/22	
Date 2022/11/07	Name forb	Name kleber	Name lang	